

Road Map



Hybrid Map



Terrain Map

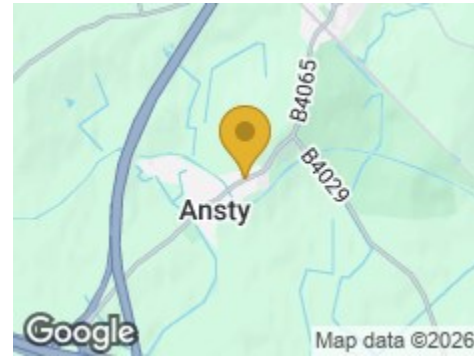

**MATTHEW JAMES**  
Property Services

Floor Plan

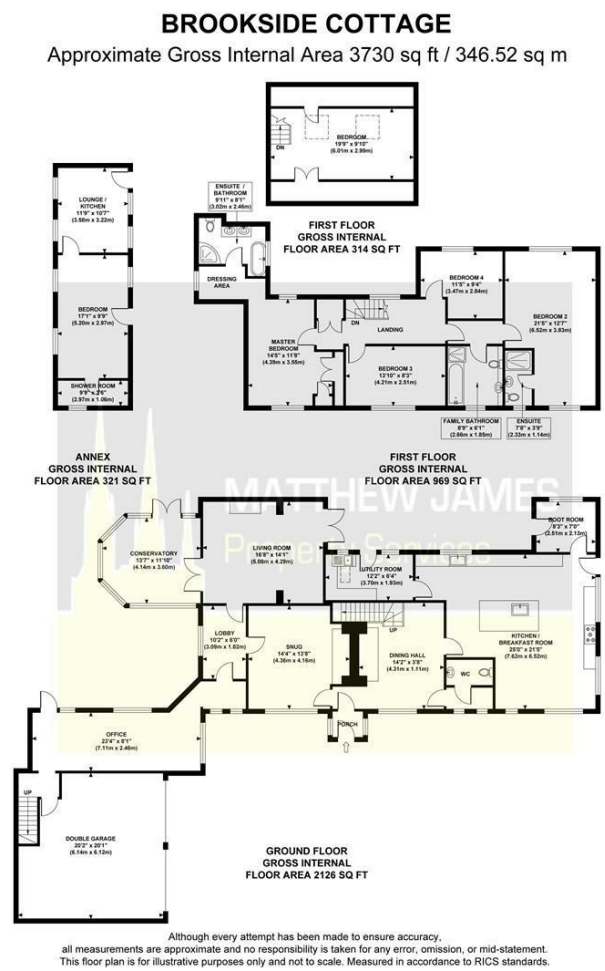

**Brookside Cottage Main Road**

Ansty, Coventry CV7 9JA

£800,000



Viewing

Please contact us on 02477 170170 if you wish to arrange a viewing appointment for this property or require further information.

Energy Efficiency Graph

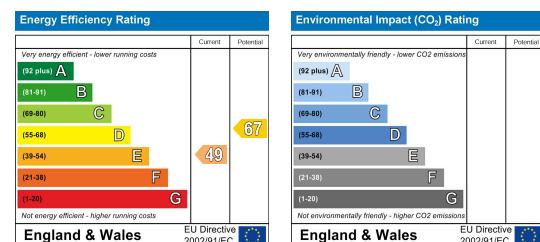

These particulars, whilst believed to be accurate are set out as a general outline only for guidance and do not constitute any part of an offer or contract. Intending purchasers should not rely on them as statements of representation of fact, but must satisfy themselves by inspection or otherwise as to their accuracy. No person in this firm's employment has the authority to make or give any representation or warranty in respect of the property.

CONTACT INFORMATION

24a Warwick Row, Coventry CV1 1EY  
02477 170170

info@matthewjames.uk.com  
www.matthewjames.uk.com

Facebook  
Twitter



# Brookside Cottage Main Road

Ansty, Coventry CV7 9JA

£800,000



Approach/ Driveway

Porch

Dining Hall

14'2 x 3'8

Ground Floor W.C

Snug

14'4 x 13'8

Living Room

16'8 x 14'1

Lobby

10'2 x 6'0

Office

23'4 x 8'1

Conservatory

13'7 x 11'10

Kitchen / Breakfast Room

26'0 x 21'5

Utility Room

12'2 x 6'4

Boot Room

8'3 x 7'0

Double Garage

20'2 x 20'1

First Floor Landing

Master Bedroom

14'5 x 11'8

Dressing Area

En Suite Bathroom

9'11 x 8'1

Bedroom Two

21'5 x 12'7

En Suite

7'8 x 3'9

Bedroom Four

13'10 x 8'3

Bedroom Five

11'5 x 9'4

Family Bathroom

8'9 x 6'1

Bedroom Three

19'9 x 9'10

Annex...

Annex Bedroom

17'1 x 9'9

Annex Shower Room

9'9 x 3'6

Annex Lounge / Kitchen

11'9 x 10'7

Outside / Grounds

Ariel View

